



## INSTRUCTION SHEET FOR TOOL #987

### 6-SPEED MAIN DRIVE CASE BEARING INSTALLER

USE ON 2006 TO PRESENT DYNA 6-SPEED MODELS

#### WHEN PERFORMING TRANSMISSION RELATED SERVICE USE THE FOLLOWING TOOLS:

- Jims No.2315 6-speed primary locker tool
- Jims No.989 6-speed mainshaft pulley nut socket
- Jims No.984 6-speed trans door remover
- Jims No.981 6-speed drive gear installer
- Jims No.985 6-speed shift fork shaft remover
- Jims No.986 6-speed main drive gear bearing & seal installer

#### Note: Read complete instructions before starting task

1. Refer to H.D. service manual per model your working on to remove trans access door and gear set, etc.
2. When you are at the point of installing your main drive gear case bearing H.D. No. 8967 into the trans case, locate two of your original trap door screws with washer No. 3249. Use these two screws with washers to mount item # 1 installer bar onto door side of case as shown in Fig.1. Note that bar is laser marked "TOP". Mount bar to door mounting holes in case with "TOP" lettering facing you. See Fig 1.
3. Next lube screw item #3 the length of shaft and install in the center hole on item # 1 installer bar as shown in Fig. 1 until screw head seats against bar .
4. Take your H.D.main bearing No.8967 and lube larger out side bearing surface. Now position bearing with letter side facing you and position into bore in case. Slip item #2 bearing cup with step side facing into bearing. Now slip bearing #5, onto #3 screw, and then nut #4.
5. Use two 3/4" box end wrenches on each end of screw #3. Turn nut #4 clockwise until bearing seats in case. Then install snap ring and case main seal per H.D. service manual.

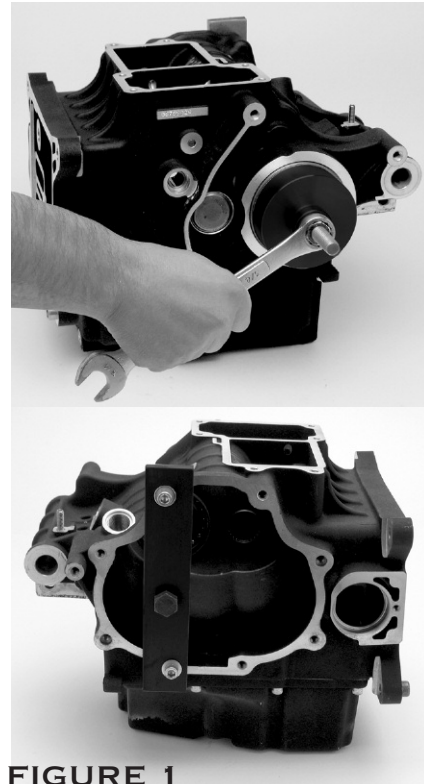
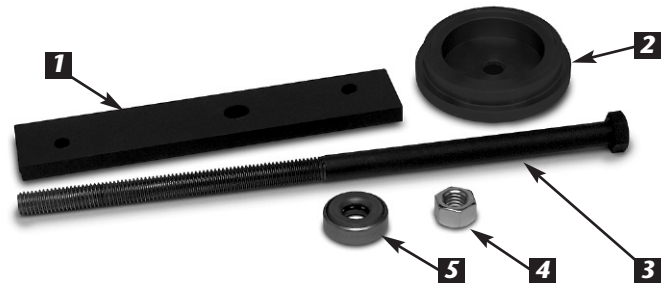

FIGURE 1



#### PARTS AVAILABLE SEPARATELY

No.	Qty.	Description	Part No.
1	1	INSTALLER BAR	987-2
2	1	BEARING CUP	987-1
3	1	SCREW	2138
4	1	NUT	2136
5	1	BEARING	2010

**CAUTION: WEAR SAFETY GLASSES. EXCESSIVE FORCE MAY DAMAGE PARTS!**  
SEE JIMS® CATALOG FOR HUNDREDS OF TOP QUALITY PROFESSIONAL TOOLS.  
THE LAST TOOLS YOU WILL EVER NEED TO BUY.

*Performance Parts For Harley-Davidson® Motorcycles*